

WESTERN CANADIAN PLACE

TENANT RETAIL DESIGN CRITERIA





TABLE OF CONTENTS

Introduction 1

Tenant Criteria 1

Retail Front Elevations 2-3

Finishes 4

Retail Front Signage & Lighting 5-6

Retail Front Entrance Doors & Security Hardware 7

Retail Front Details 8

INTRODUCTION

QiadReal is a leader in retail and commercial development and is upgrading the retail experience in Western Canadian Place. The new concept will be accessible and embody refinement and sophistication to compete with the surrounding commercial towers. The strategy is to standardize the retail program to increase flexibility and reflect cohesion with the new Atrium renovations.

TENANT CRITERIA

The special attention to the retail fronts and signage will recognize and enhance the new renovations and revitalization to the Western Canadian Place Atrium and Podium. Tenant retail fronts will be standardized by offering only a few carefully selected options for materials and finishes. The design elevations will also be consistent with each tenant. All signage will promote brand imagery but will be carefully assessed to accentuate the development of retail design on this project. Tenants will provide a design of details and signage that will create a visual presentation reflective of the proposed retail guidelines.

Retail Front Guidelines
(Elevations page)

All retail front elevations will be standardized with wood veneer surround and frameless glass entrance. Food service areas have a choice between standard wood and glass entrance or sliding security grille. The front panels will be a choice of:

- Clear glazing (Tenant Standard Option)
- Clear glazing with film (Tenant Standard Option)
- Solid drywall partition complete with Acid Etched Mirror (AEM1) finish on corridor side(Tenant Premium Option)

The amount of allowable solid retail frontage must be reviewed and approved by the landlord.

RETAIL FRONT ELEVATIONS

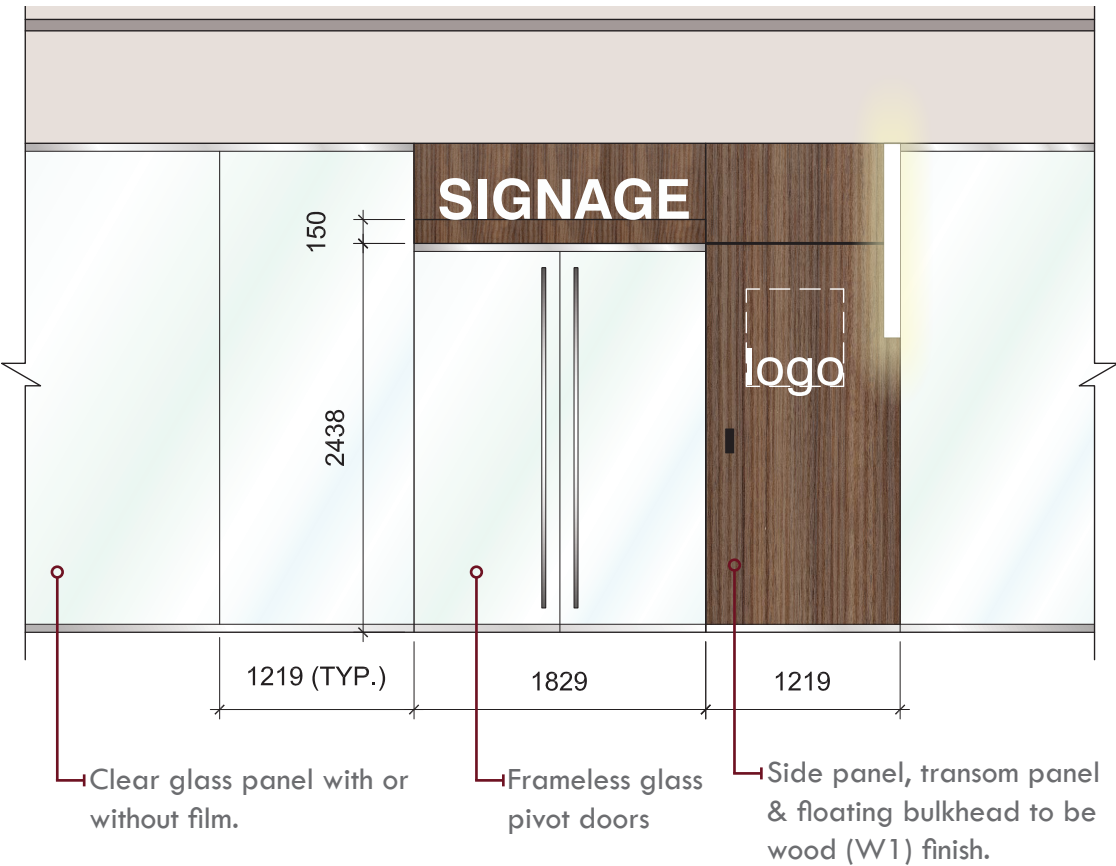

STANDARD RETAIL FRONT ELEVATION

RETAIL FRONT ELEVATIONS

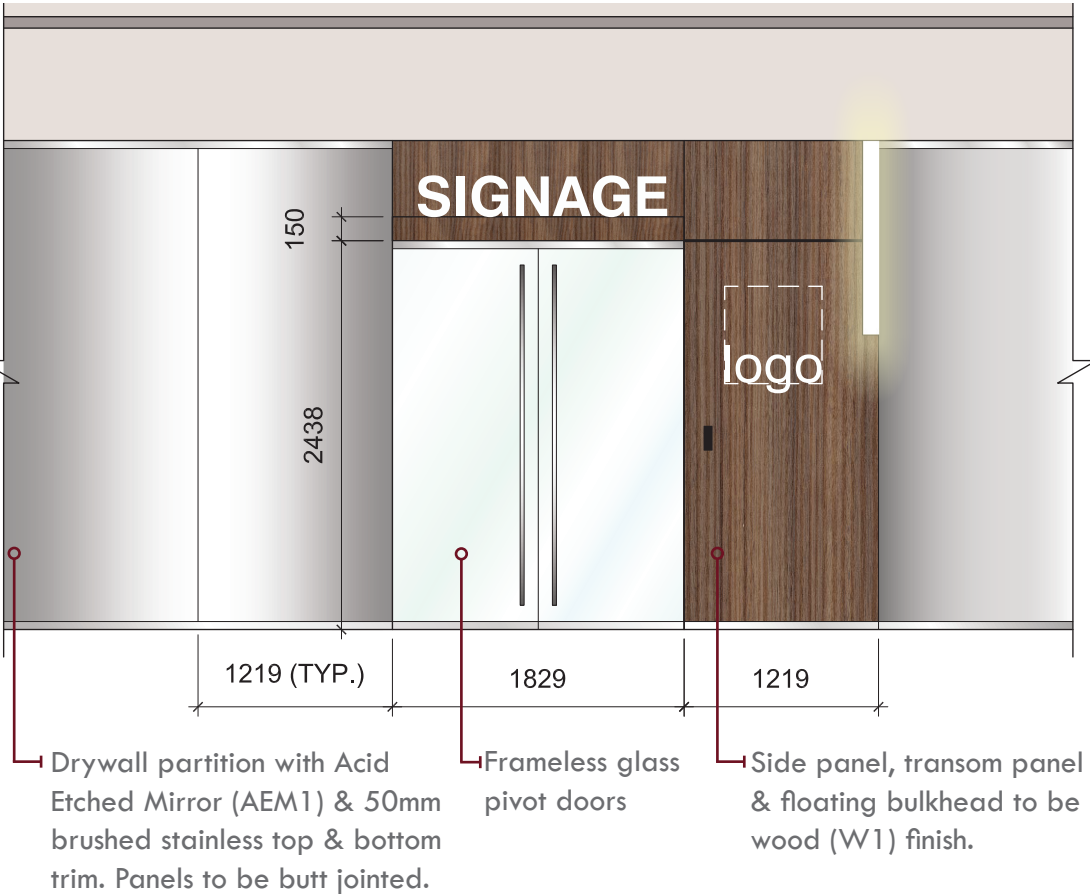

PREMIUM RETAIL FRONT ELEVATION

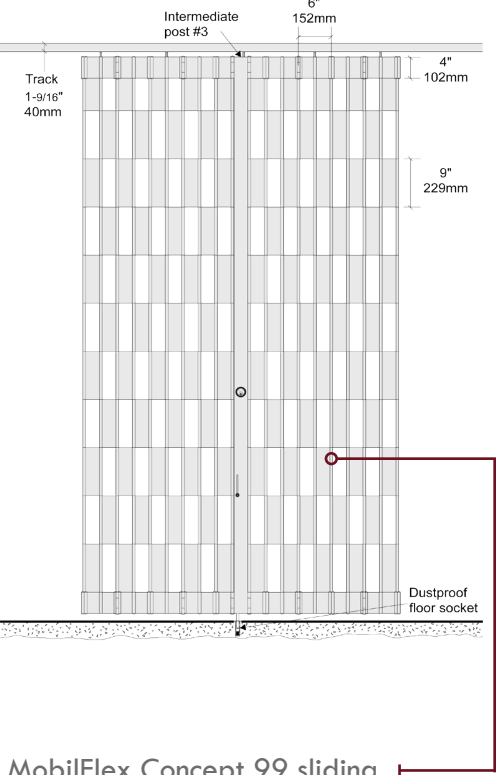

MobilFlex Concept 99 sliding grille system, finish to be white.

OPTIONAL SLIDING GRILLE FRONT (food service area only)

FINISHES



Acid Etched Mirror(AEM1) - Premium Tenant Option
Manufacturer: Goldray
Product: Walker Glass Acid Etched Mirror
Note: 6mm Starphire laminated glass complete with polished edges



Clear Glass - Tenant Standard
Product: 13mm clear tempered glass
Finish: Optional vinyl film - 3M Illumina-G to full extent of glass panels (fixed panels only).



Wood Veneer (W1) - Tenant Standard
Species: Walnut
Cut: Quarter Cut
Stain: To match plastic laminate Abet Laminati 626, Grainwood

RETAIL FRONT SIGNAGE & LIGHTING

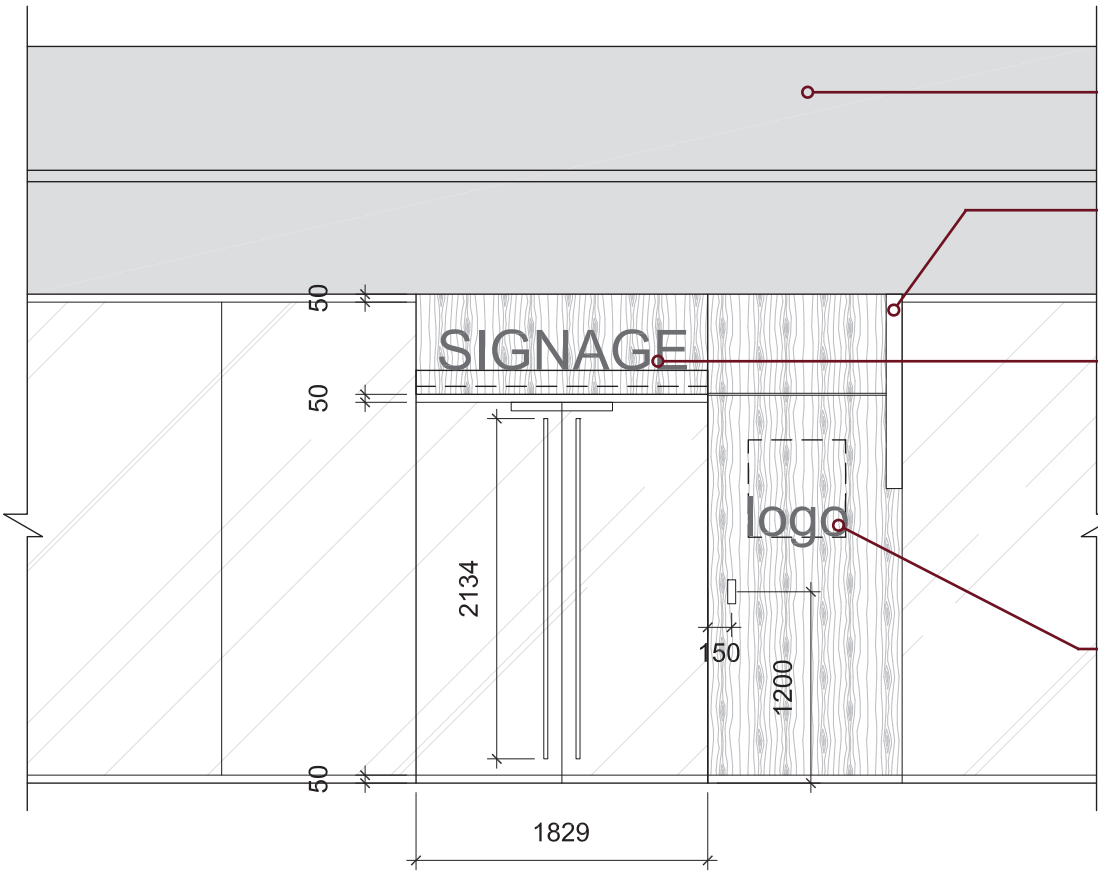

Existing granite to remain.

Light fixture

Dimensional lettering for retail signage display. Maximum signage height to be 10" (250mm). Signage font, finish & color to be determined by retailer.

Optional logo signage location. Logo to be dimensional lettering/symbol to match signage above. maximum logo size to be 2'x2' (610mm x 610 mm)

RETAIL FRONT SIGNAGE & LIGHTING



Led Strip Light
Manufacturer: 3G Lighting
Distributor: Optics Lighting
Style: Surface Mount Kubo Collection
Catalogue No. : 3G-SLKU 448-28LED-30K-120-E-SV
Size: 4"W x 4"D x 48"L

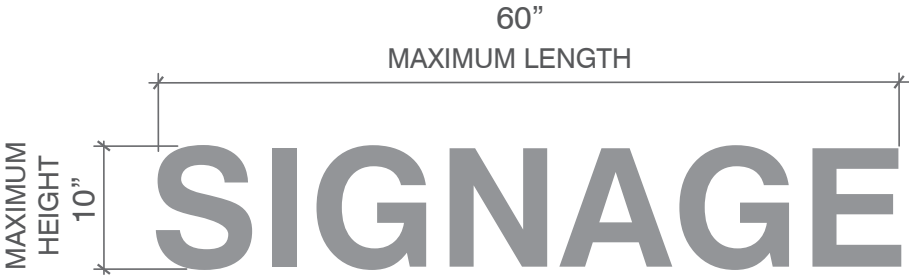

Custom Retail Signage/Logo
Style: Non-Illuminated dimensional lettering
Note: Custom design, font, finish & colour to determined by each tenant

RETAIL FRONT ENTRANCE DOORS & SECURITY HARDWARE

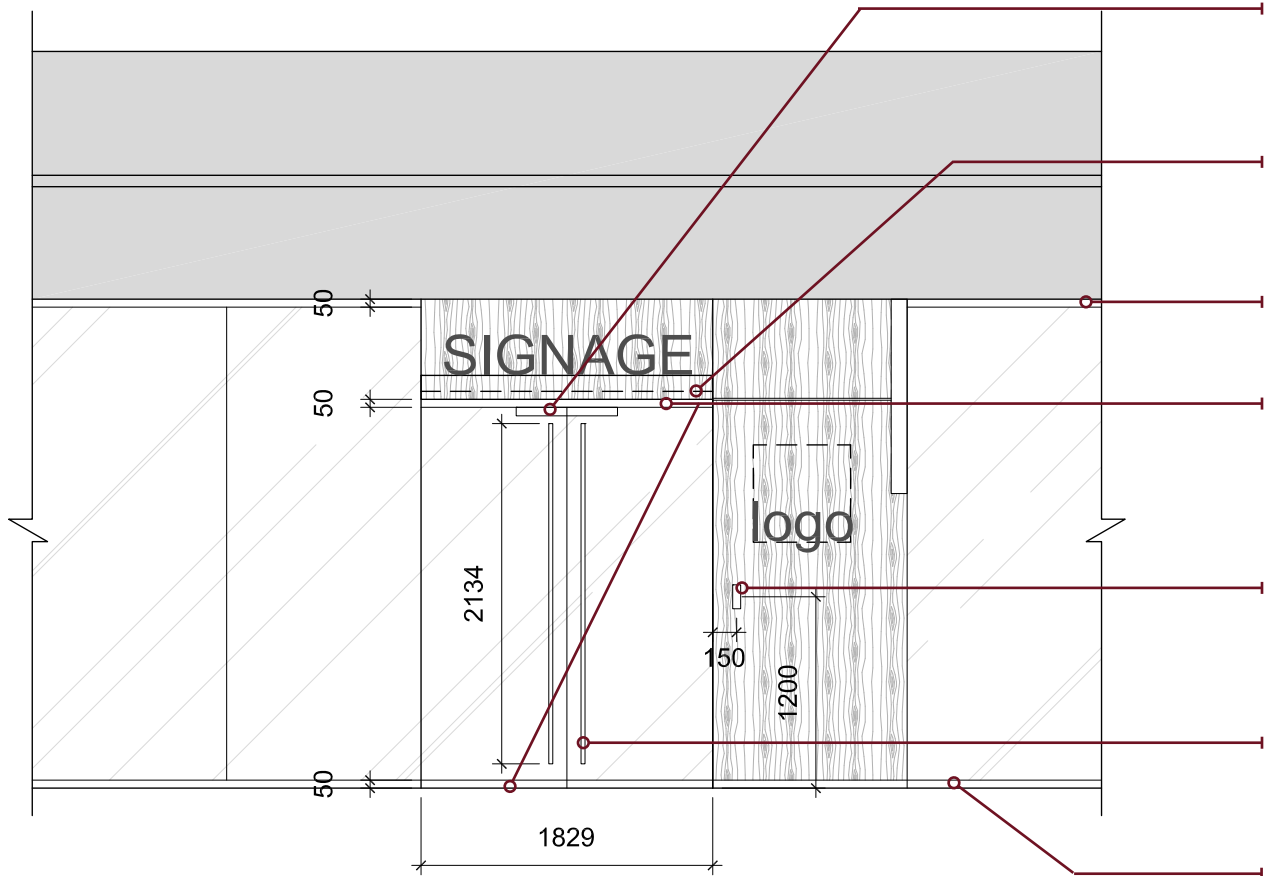

- CRL narrow profile electro-magnetic lock. #SDC352A
- CRL concealed door header c/w concealed closers. #HB127110A72
- CRL 2" head channel, brushed stainless finish. #C7502BS
- CRL low profile door rail c/w concealed pivot hinges, & lock (bottom rail only), brushed stainless finish. #DR2SBS12CL
- Card reader HID multiCLASS SE Reader #RP10900P, black, confirm specifications with QiadReal.
- Standard Metal D352 x D352 x #5 x 13mm door thickness x brushed stainless steel finish.
- CRL low profile sidelite rail, brushed stainless finish. #SR2SBS12SL

RETAIL FRONT DETAILS

1. RETAIL FRONT PLAN DETAIL

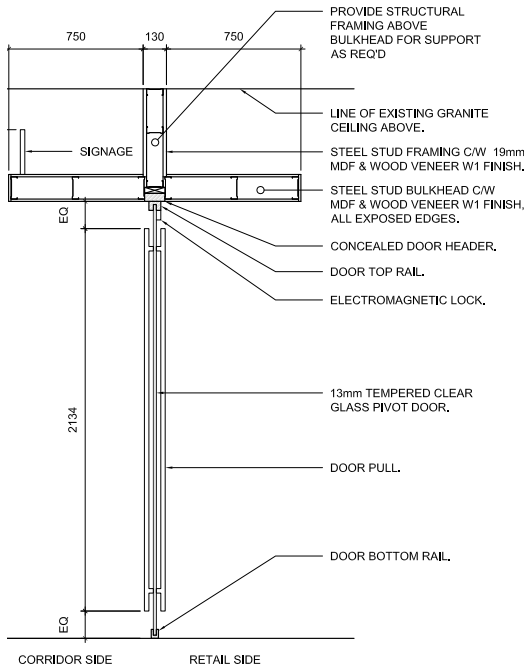
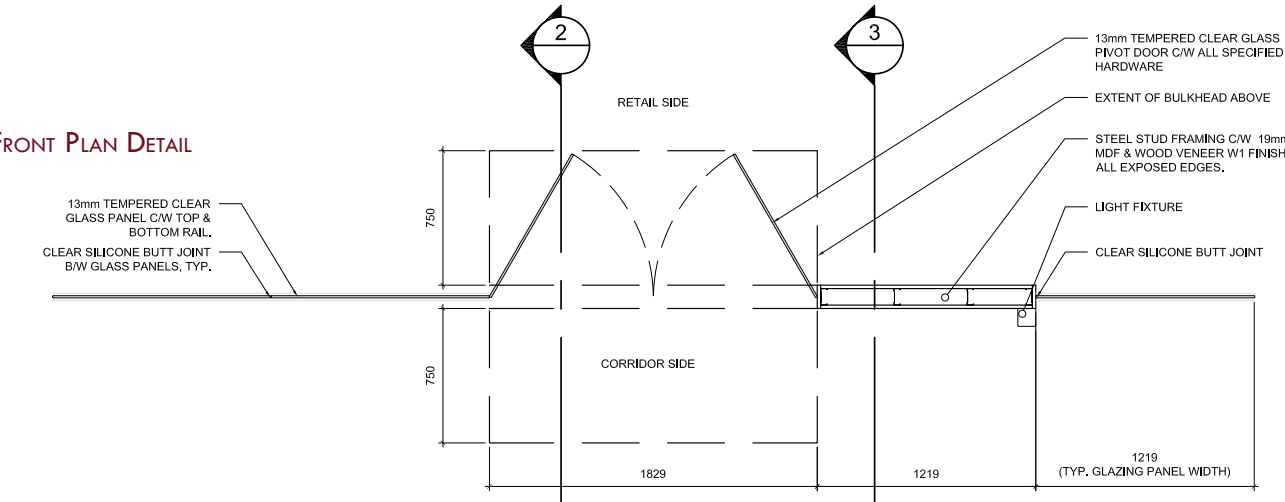

2. DOOR/BULKHEAD SECTION

3. Side Panel Section

